

Data sheet - Support roller STO 25TN X (cylindrical, with inner ring)

Designation	STO 25 X
Type	cylindrical
D [mm]	52
d [mm]	25
F, Fw * [mm max.]	30
B1 [mm]	16
B [mm]	15,8
d1 [mm]	37
r [mm]	0,3
Dynamic load Crw [N]	16500
Static load C0rw [N]	22900
Speed limit [min-1]	3600

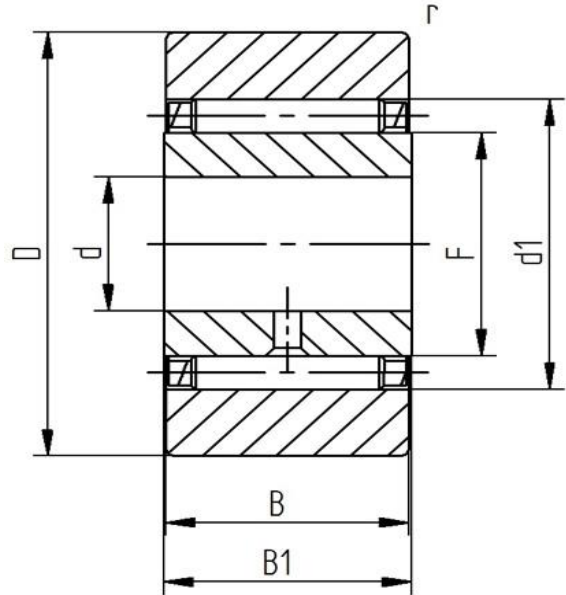

Every specification has been edited and verified carefully. STI Bearings GmbH assumes no liability for potential errors or incompleteness. Technical modifications are subject of changes.
 © 2020 by STI Bearings GmbH
 Reproduction, even excerpts, only with our approval.